

LKM7000 Lock Series Standoff Kit

The Standoff Kits are used to prevent a Hollow Metal Door from compressing during installation of the LKM7000. Once the holes are all drilled, install the 6 set screws followed by the stand offs with thread locker onto the back of the LKM7000 outside assembly. Use the short 1/4"-20 socket head mountings supplied with the standoff kit in place of the longer supplied in the LKM7000 accessory pack.

Standoff Kits are available in 1 3/4", 2" & 3" thick doors.

LKM7000SOK1 – 1 3/4" Door

LKM7000SOK – 2" Door

LKM7000SOK3 – 3" Door

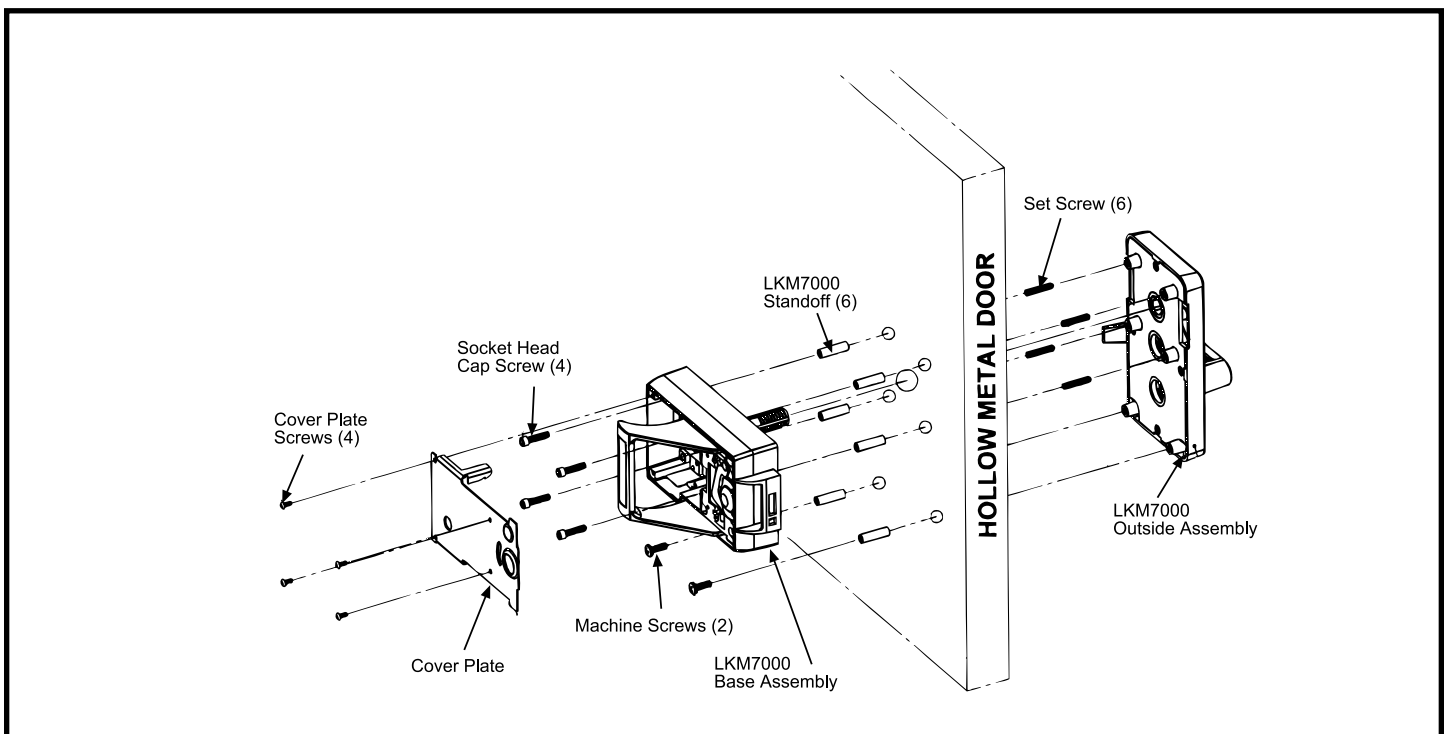

LOCKMASTERS[®]
I N C O R P O R A T E D